

Chimney fan with integrated grease drain

GSV

The Exodraft Grease Fan chimney fan with integrated grease drain is a specially built exhaust fan with a vertical discharge for grills and kitchen exhaust.

When mounted on top of a chimney the chimney fan generates a vacuum in the flue pipe and in the chimney. The grease fan is especially suitable for grills and kitchen exhausts. With its integrated grease drain, grease drip pan and exchangeable granule cushion it is the ideal solution for greasy exhaust air.

All Exodraft chimney fans are built for temperatures up to 250°C in continuous rating and made from cast aluminium. All screws and bolts are stainless steel.

The motor is a temperature-resistant, encapsulated induction motor with sealed and maintenance-free ball bearings, sitting outside the air volume flow.

The cable is heat-resistant, strain-relieved and shielded externally with a reinforced hose. These measures give the chimney fan high operational reliability and long service life.

The grease fan chimney fan is hinged, allowing chimney cleaners to easily clean the chimney and enabling easy regular cleaning.

The drain opening is fitted with a stainless steel grid as finger and bird protection.



Technical data

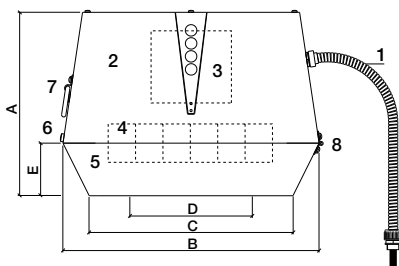

1. Connecting cable
2. Upper part
3. Motor
4. Impeller
5. Lower part
6. Locking screws
7. Handle
8. Hinge



Integrated fat drain on the Grease Fan

Model	Motor data				Weight kg	Dimensions [mm]				
	rpm	V	Amp	kW*		A	BxB	CxC	D [Ø]	E
GSV315-41	1400	1 x 230	1.80	0.37	37	427	651	522	280	130
GSV400-41	1400	1 x 230	2.60	0.40	47	427	651	522	280	130
GSV400-42**	1445	3 x 230	2.95	0.75	52	427	651	522	280	130

* Power consumption for ambient temperature of 20°C

** Frequency converter required

Density class IP54, Insulation class F.

Capacity diagrams

GSV315-41 and GSV400-41

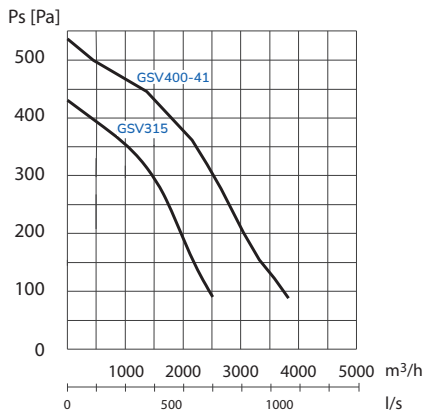

GSV400-42

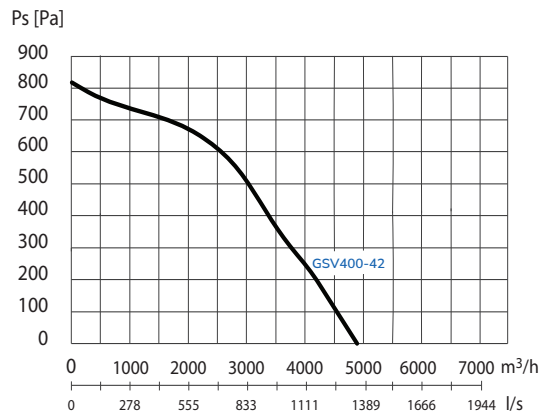

Accessories

Because of the integrated grease drain of the grease fan and appropriate accessories any grease or oil flows into the specially configured drip pan which is easy to empty and clean. The fleece in the pan binds the grease or oil and can easily be exchanged.

